



25<sup>th</sup> Annual

---

# ENTER Jamboree

---

April 4-5, 2019

Tilburg University

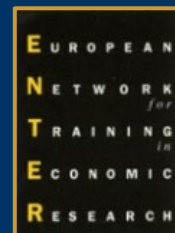

## **Welcome to the 2019 ENTER Jamboree at Tilburg University!**

Welcome to Tilburg! We're happy to host the 25th ENTER Jamboree and bring together PhD students and faculty from across the ENTER Network.

On the first day of the conference, you can find our volunteers stationed at the Tilburg Universiteit train station, the bus stops closest to the campus, and on our campus. You can recognize them by their dark blue "Tilburg University" caps.

### **Don't forget to follow the Jamboree on Twitter!**

You can follow @enter\_2019 for updates and tweets about the conference, and use #ENTERJamboree for your own tweets.

### **Helpful telephone numbers:**

Tilburg University Security Office: +31 13 466 3000

Tilburg Department of Economics Secretaries' Office: +31 13 466 8078

For questions regarding the event, you can contact Aislinn Callahan-Brandt (a.r.callahan AT uvt DOT nl) or Patricio Dalton (p.s.dalton AT uvt DOT nl).

## **Table of Contents**

Program Quick Overview	1
Campus Map	2
C Building Map: Ground Floor	3
C Building Map: 1st Floor	4
Faculty Coordinators	5
Student Coordinators	5
Administrative Coordinators	5
Program Thursday 4 April	6
Program Friday 5 April	9
Public Transportation – Buses	12
Public Transportation – Trains	13
Driving to & Parking on Campus	14
Minutes	15
Notes	19

## **Program Quick Overview**

### **Thursday 4 April 2019**

- 9.00-9:30: Registration & Morning Coffee
- 9.30-10.35: Welcome Address & Plenary Session 1
- 10.35-11:10: Coffee Break
- 11.10-12.30: Parallel Session 1
- 12.30-14:00: Lunch
- 14.00-16.00: Parallel Session 2
- 16.00-16.30: Coffee Break
- 16.30-17.30: Plenary Session 2
- 17.30-18.30: ENTER Student coordinator meeting
- 18.15-19.30: LOC Brewery Tour & Tasting
- 20.00-22.30: Dinner at Houtloods Restaurant

### **Friday 5 April 2019**

- 9.00-9.30: Morning Coffee
- 9.30-10.30: Plenary Session 3
- 10.30-11:10: Coffee Break
- 11.10-12.30: Parallel Session 3
- 12.30-14.00: Lunch
- 14.00-16.00: Parallel Session 4
- 16.00-16.30: Coffee Break
- 16.30-17.30: Plenary Session 4
- 17.30-18.30: ENTER Faculty meeting
- 19.00-21.30: Faculty Dinner at Auberge Restaurant

## Campus Map



## C Building: Ground Floor

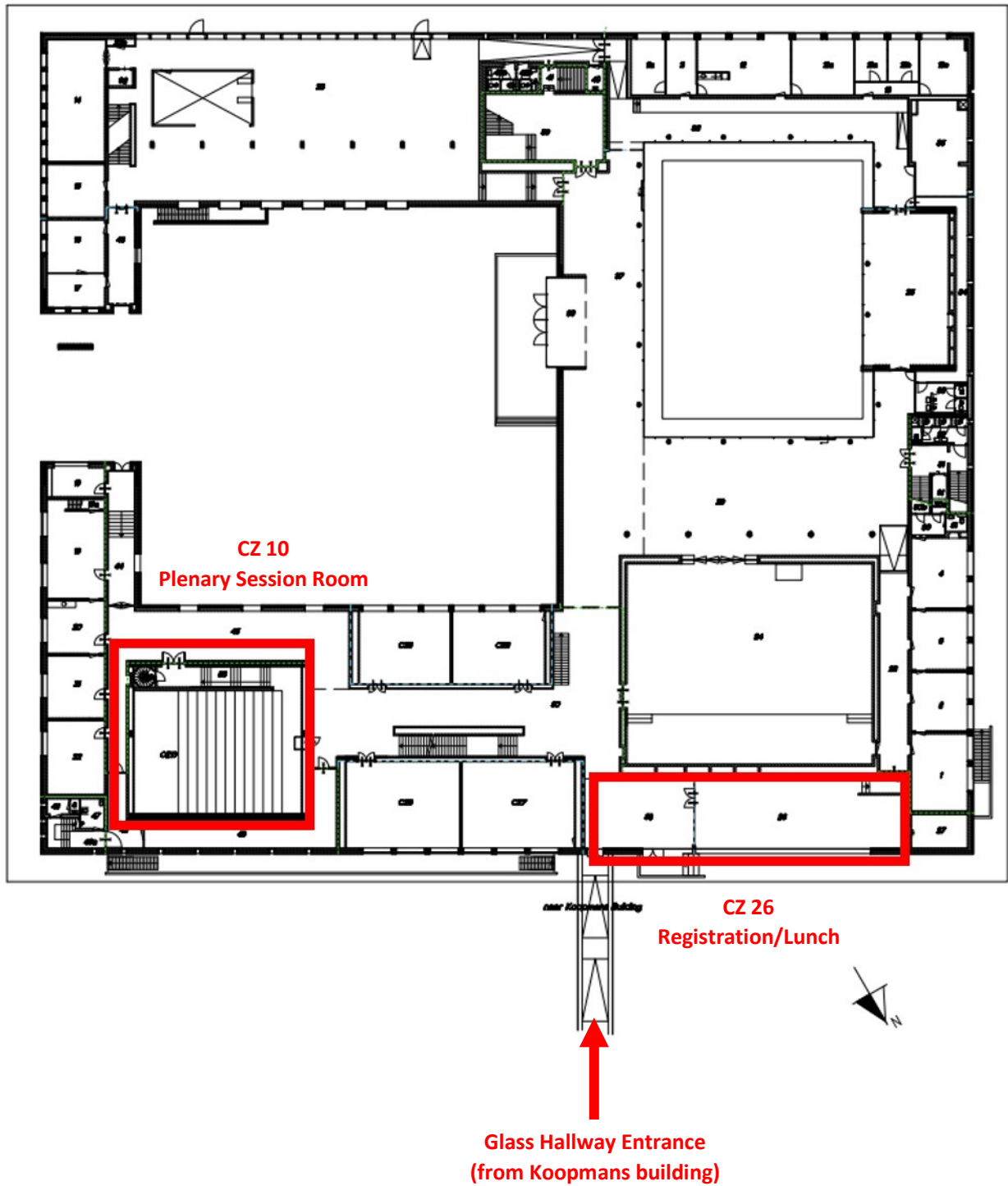

## C Building 1st Floor



## Coordinators

### Faculty Coordinators

Philippe Bontems  
*Université de Toulouse (TSE)*

Patricio Dalton  
*Tilburg University (TiSEM)*

Andrés Erosa  
*Universidad Carlos III de Madrid (UC3M)*

Sten Nyberg  
*Stockholm University (IIES)*

Francesc Obiols  
*Universitat Autònoma de Barcelona (UAB)*

Ian Preston  
*University College London (UCL)*

Federica Romei  
*Stockholm School of Economics (SSE)*

Philip Verwimp  
*Université libre de Bruxelles (ULB)*

Ulrich Wagner  
*University of Mannheim*

### Student Coordinators

Christine Alamaa  
*Stockholm University (IIES)*

Lisa Bagnoli  
*Université libre de Bruxelles (ULB)*

Barbara Boelmann  
*University College London (UCL)*

Alipio Ferreira Cantisani  
*Université de Toulouse (TSE)*

Bruno Conte  
*Universitat Autònoma de Barcelona (UAB)*

Federico Curci  
*Universidad Carlos III de Madrid (UC3M)*

Tillman Heidelk  
*Université libre de Bruxelles (ULB)*

Daniel Karpati  
*Tilburg University (TiSEM)*

Gosia Majewska  
*Université de Toulouse (TSE)*

Ursula Mello  
*Universidad Carlos III de Madrid (UC3M)*

Tomasz Olma  
*University of Mannheim*

Afrola Plaku  
*Université libre de Bruxelles (ULB)*

Zoltan Racz  
*Stockholm School of Economics (SSE)*

Laura Capera Romero  
*Tilburg University (TiSEM)*

Guilherme Garcia Teijeiro  
*Stockholm School of Economics (SSE)*

Claire Thürwächter  
*Stockholm School of Economics (SSE)*

Sarah Zoi  
*Universitat Autònoma de Barcelona (UAB)*

### Administrative Coordinators

Aislinn Callahan-Brandt  
*Tilburg University (TiSEM)*

Golareh Khalilpour  
*University of Mannheim*



## **Program Thursday 4 April 2019**

### **Registration & Morning Coffee (9.00-9:30)**

**CZ 26**

### **Welcome Address & Plenary Session 1 (9.30-10.35)**

**CZ 10**

**Welcome Address:** Joost Driessen (Vice-Dean of Research, TiSEM) & Patricio Dalton (TiSEM)

**Chair:** Patricio Dalton (TiSEM)

Han Ye (Mannheim): The Labor Supply Effects of Unemployment Insurance for Older Workers

Matthias Kredler (UC3M): Risk-Sharing with a Central Authority: Free-Riding, Lack of Commitment, & Bailouts

### **Coffee Break (10.35-11:10)**

**Hallway outside of CZ 10**

### **Parallel Session 1 (11.10-12.30)**

#### **Macroeconomics 1 (CZ 109)**

**Chair:** Dorothee Hillrichs (TiSEM)

Friedrich Lucke (TSE): Repeated Bailouts & Austerity  
Discussant: Marco Pinchetti (ULB)

Timo Reinelt (Mannheim): The Misallocation Channel of Monetary Policy  
Discussant: Claire Thürwächter (SSE)

#### **Labor Economics (CZ 110)**

**Chair:** Andrew Proctor (SSE)

Amir Habibi (UCL): Pay Transparency in Organizations  
Discussant: Andrew Proctor (SSE)

Miguel Zerecero (TSE): The Aggregate Effects of Labor Market Concentration  
Discussant: Sergio A. Feijóo Moreira (UC3M)

#### **Theory (CZ 118)**

**Chair:** Yaxin Li (TSE)

Chaoran Sun (UAB): Value-Free Reduced Game Operators: An Axiomatic Approach  
Discussant: Roweno Heijmans (TiSEM)

Jesús Sánchez Ibrahim (UAB): A Theory of Political Polarization & Public Opinion  
Discussant: Yaxin Li (TSE)

#### **Behavioral Biases (CZ 119)**

**Chair:** Sebastian Seitz (Mannheim)

Xiaoyu Wang (TiSEM): Litigation & Settlement under Loss Aversion  
Discussant: Yadi Yang (TiSEM)

Jamie Hentall MacCuish (UCL): Rational Inattention & Oversensitivity of Retirement to the State Pension Age  
Discussant: Sebastian Seitz (Mannheim)

**Lunch (12.30-14.00)**

**CZ 26**

**Parallel Session 2 (14.00-16.00)**

***Applied Microeconomics 1 (CZ 109)***

**Chair:** Ana Moura (TiSEM)

Stefano Falcone (ULB): Technological Change, Organizational Capacity & Rural Conflict: Land Occupations in Brazil  
Discussant: Ursula M. Mello (UC3M)

Ruben Pobleto (UCL): Crime & Punishment: Do Politicians in Power Receive Special Treatment in Courts? Evidence from India  
Discussant: Ana Moura (TiSEM)

***Industrial Organization 1 (CZ 110)***

**Chair:** Alessandro Ruggieri (UAB)

Sebastián Vergara (TSE): All-Units-Discount Contracts as a Delaying & Deterring Instrument  
Discussant: Sven Hanold (UAB)

Angela Capolongo (ULB): Cyclical Behavior of Markups: Theory & Firm-Level Evidence  
Discussant: Alessandro Ruggieri (UAB)

***Trade (CZ 111)***

**Chair:** Thijs Brouwer (TiSEM)

Dorothee A. Hillrichs (TiSEM): Recovering Within-Country Income Inequality from Trade Data  
Discussant: Tommaso Santini (UAB)

Bengt Söderlund (Stockholm SSE): The Importance of Face-to-Face Communication for Trade: Evidence from the Liberalization of the Soviet Airspace  
Discussant: Thijs Brouwer (TiSEM)

***Networks (CZ 119)***

**Chair:** Kasper Kragh-Sørensen (IIES)

Alessandra Allocca (Mannheim): “No Man Is an Island” Estimating the Determinants of Working Collaborations  
Discussant: Alessandro Toppeta (UCL)

Daniel Salinas (ULB): Identification of Network Effects on Inequality of Opportunities  
Discussant: Kasper Kragh-Sørensen (IIES)

**Coffee Break (16.00-16.30)**

*Hallway outside of CZ 10*

**Plenary Session 2 (16.30-17.30)**

**CZ 10**

**Chair:** Patricio Dalton (TiSEM)

Jan Boone (TiSEM): A Bayesian approach to modelling health care expenditures using Python

Federica Romei (SSE): Sovereign Default in a Monetary Union

**ENTER Student coordinator meeting (17.30-18.30)**

**CZ 119**

**LOC Brewery Tour (18:15-19.30)**

Burgemeester Brokxlaan 8-84, 5041 SB Tilburg

**Dinner (20.00)**

Burgemeester Brokxlaan 1041, 5041 RP Tilburg

## **Program Friday 5 April 2019**

### **Morning Coffee (9.00-9:30)**

*Hallway outside of CZ 10*

### **Plenary Session 3 (9.30-10.30)**

**CZ 10**

**Chair:** Patricio Dalton (TiSEM)

Glenn Magerman (ULB): Price Updating with Production Networks

Jean Marie Lozachmeur (TSE): Catching them young: early childhood care, human capital and tax policy

### **Coffee Break (10.30-11:10)**

*Hallway outside of CZ 10*

### **Parallel Session 3 (11.10-12.30)**

***Applied Microeconomics 2 (CZ 109)***

**Chair:** Maximilian Jager (Mannheim)

Zanna Iscenko (UCL): Strictly Dominated Mortgage Choices: Evidence from the UK

Discussant: Tomás Rodríguez-Martínez (UC3M)

Beni Kouevi-Gath (ULB): Information Sharing & Bank Risk-Taking Behavior: Evidence from Sub-Saharan African Banks

Discussant: Maximilian Jager (Mannheim)

### ***Macroeconomic Policy (CZ 110)***

**Chair:** Karin Kinnerud (IIES)

Markus Karlman (IIES): Removing the Mortgage Interest Deductibility: Policies & Welfare Effects

Discussant: Esteban Callejas Perez (ULB)

R. V. Jaimes Bonilla (TiSEM): Optimal Climate & Social Policy in an OLG Economy

Discussant: Karin Kinnerud (IIES)

### ***Human Capital (CZ 122)***

**Chair:** Tingting WuVera (UAB)

Emiel Jerphanion (TiSEM): Investment in Female Human Capital & Marital Gains

Discussant: José Alfonso Muñoz Alvarado (TSE)

Yasemin Özdemir (Mannheim): Responsiveness of Parental Investment During Adolescence

Discussant: Tingting WuVera (UAB)

### ***Industrial Organization 2 (CZ 123)***

**Chair:** Anna Vitali (UCL)

Michele Rosemberg (UC3M): The Political Economy of the Industrial Revolution: Local institutions and Industrial Development  
Discussant: Christine Alamaa (IIES)

Bartosz Korchowiec (UAB): Job Automation & Worker Reallocation  
Discussant: Anna Vitali (UCL)

**Lunch (12.30-14.00)**  
**CZ 26**

**Parallel Session 4 (14.00-16.00)**

**Macroeconomics 2 (CZ 109)**

**Chair:** Peter Neis (TSE)

Hugo van Buggenum (TiSEM): Risk, Inside Money, & the Real Economy  
Discussant: Morgane Richard (UCL)

Gaurav Mehta (UAB): Expectations & the Option Implied Volatility: Evidence & Some Theory  
Discussant: Peter Neis (TSE)

**Government Policy (CZ 110)**

**Chair:** Felix Holub (Mannheim)

Luis Rodrigo Arnabal (TSE): Legalizing Marijuana: Government Participation & Optimal Policies  
Discussant: Anousheh Alamir (ULB)

Onursal Bağırhan (UC3M): Dynamics of Tax Amnesties  
Discussant: Felix Holub (Mannheim)

**Information (CZ 122)**

**Chair:** Elizaveta Pronkina (UC3M)

Ittai Schacham (TiSEM): Information vs. Regulation: A Case Study of Israeli Television  
Discussant: Gokce Gokkoca (TSE)

Yihan Yan (Mannheim): Does Open Source Pay off in PHEV Industry? A Study of Tesla's Open-Source Initiative  
Discussant: Elizaveta Pronkina (UC3M)

**Immigration (CZ 123)**

**Chair:** Elise Petit (ULB)

Ismael Gálvez Iniesta (UC3M): The Role of Immigration in a Deep Recession: The Case of Spain  
Discussant: Wenchao Jin (UCL)

Martin Hagen (UC3M): Refugee Relocation: A Procurement Perspective  
Discussant: Elise Petit (ULB)

**Coffee Break (16.00-16.30)**

**Hallway outside of CZ 10**

**Plenary Session 4 (16.30-17.30)**

**CZ 10**

**Chair:** Patricio Dalton (TiSEM)

Pau Milan (UAB): Informal Risk Sharing with Local Information

Vincent Sterk (UCL): On Quantitative Easing

**ENTER Faculty meeting (17.30-18.30)**

**CZ 122**

**Faculty Dinner at Auberge Restaurant (19.00)**

Bredaseweg 441, 5036 NA Tilburg

## Public Transportation - Buses

Arriva services the buses in Tilburg. You can buy a ticket on the bus using your debit card (PIN) or credit card. Please note that you cannot purchase a ticket with cash on the bus. If you prefer to use cash, you can purchase a ticket at the Arriva Service Center, located on the north side of the Tilburg Central Train Station (Station Tilburg) (Monday-Friday: 08.00-18.00, Saturday: 09.00-18.00, Sunday: 10.00-17.00).

**Starting at city center Tilburg:** The main bus station is located on the north side of the Tilburg Central Train Station (Station Tilburg). To go to the university, you can take Bus 2 (direction Reeshof), 3 (direction Reeshof-Koolhoven), or 4 (direction Reeshof).

A round trip (return) ticket between Station Tilburg and the university costs approximately €2.90 and is valid for the line it was purchased. A Day Ticket costs approximately €6.65 and is valid on multiple bus lines.

**Bus 2 and 3:** Exit the bus at the stop for Conservatoriumlaan. From the bus stop, walk west on Professor Cobbenhagenlaan. Cross over Conservatoriumlaan and continue on Professor Cobbenhagenlaan. Turn left onto Hogeschoollaan. Turn right onto the tree-lined pedestrian path (marked by a Tilburg University sign and map). Follow this path straight to the Cobbenhagen building. When you reach the building, there will be a door immediately to your right. Enter the building and follow the hall to the registration desk.

**Bus 4:** Exit the bus at the stop for Universiteit van Tilburg/Tilburg University. From the bus stop, turn left onto Hogeschoollaan. Turn right onto the tree-lined pedestrian path (marked by a Tilburg University sign and map). Follow this path straight to the Cobbenhagen building. When you reach the building, there will be a door immediately to your right. Enter the building and follow the hall to the registration desk.



## **Public Transportation - Trains**

Nationale Spoorwegen (NS) services trains in the Netherlands. You must have a valid ticket in order to enter or leave a station via the yellow check-in/check-out ticket scanners. You must be able to produce a valid ticket to NS officials upon request, failure to do so will result in a €50 fine, plus the cost of the trip, paid in cash.

At some stations, including Station Tilburg, you must scan a ticket to open a gate at the entrance/exit. At stations without a gate, including the Station Tilburg Universiteit (the university station), you are still required to check in and out. If you purchase a day ticket or return ticket but do not check out when you arrive at the university, you will invalidate your return trip. You do not need to check out at gateless stations if you are using a ticket purchased and printed from the NS website or a mobile ticket purchased via the NS app.

You can purchase one-way or return tickets at the ticket machines at any station with a debit card (PIN), or you can purchase your ticket online at [www.ns.nl/en](http://www.ns.nl/en) using a credit card. You can also purchase a ticket in the NS app on your mobile telephone.

The stop at the university is “Tilburg Universiteit”. You can plan your trip using [www.ns.nl/en](http://www.ns.nl/en) (or the app). After arriving at Station Tilburg Universiteit, scan your ticket at a marked scanning pole walk south on Conservatoriumlaan. Turn right onto Professor Verbernelaan. At the end of the street, you will cross over to the pedestrian walkway of the University (Universiteitslaan). Take this to the 4-way crossing and turn left. Enter the large building (Koopmans building) at the top of the rise, and walk through the glass hallway to the Cobbenhagen building. You will see the registration desk upon entering the Cobbenhagen building.

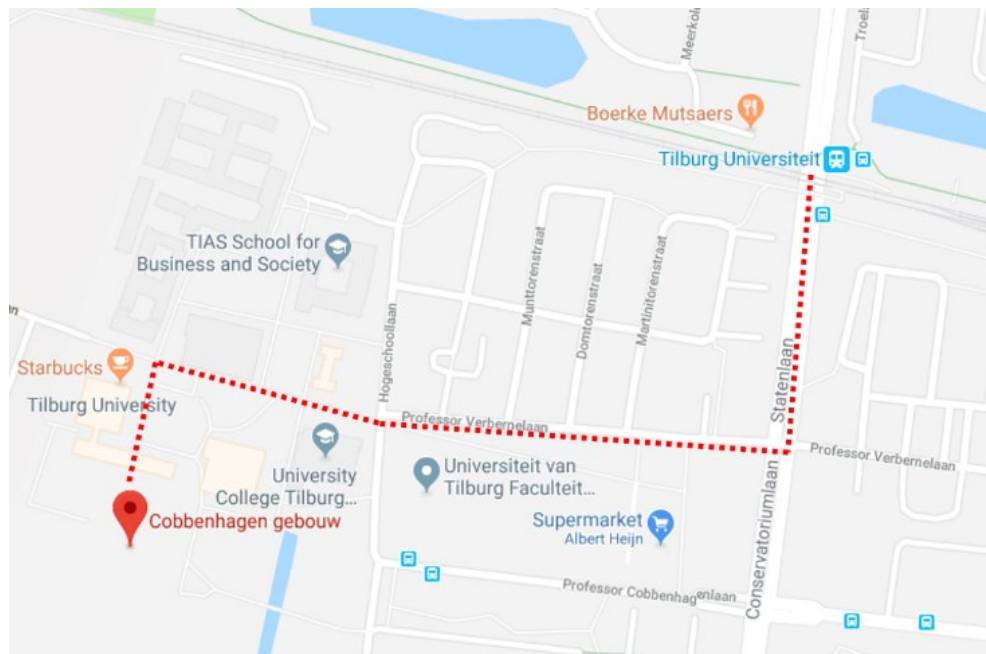



## Driving to & Parking on Campus

Use the University visiting address for your GPS: Warandelaan 2, 5037AB Tilburg.

Please note that parking at the university is free. There are 3 parking lots on the campus.

Parking lots 1 and 2 can be reached by following the GPS instructions for the visitor's address. After parking, follow the walking path to the 4-way crossing. Enter the large building (Koopmans building) at the top of the rise, and walk through the glass hallway to the Cobbenhagen building. You will see the registration desk upon entering the Cobbenhagen building.

Parking lot 3 is located on Hogeschoollaan. If you park in this lot, walk south on Hogeschoollaan and turn right onto the pedestrian path (marked by a Tilburg University sign and map). Follow this path straight to the Cobbenhagen building. When you reach the building, there will be a door immediately to your right. Enter the building and follow the hall to the registration desk.

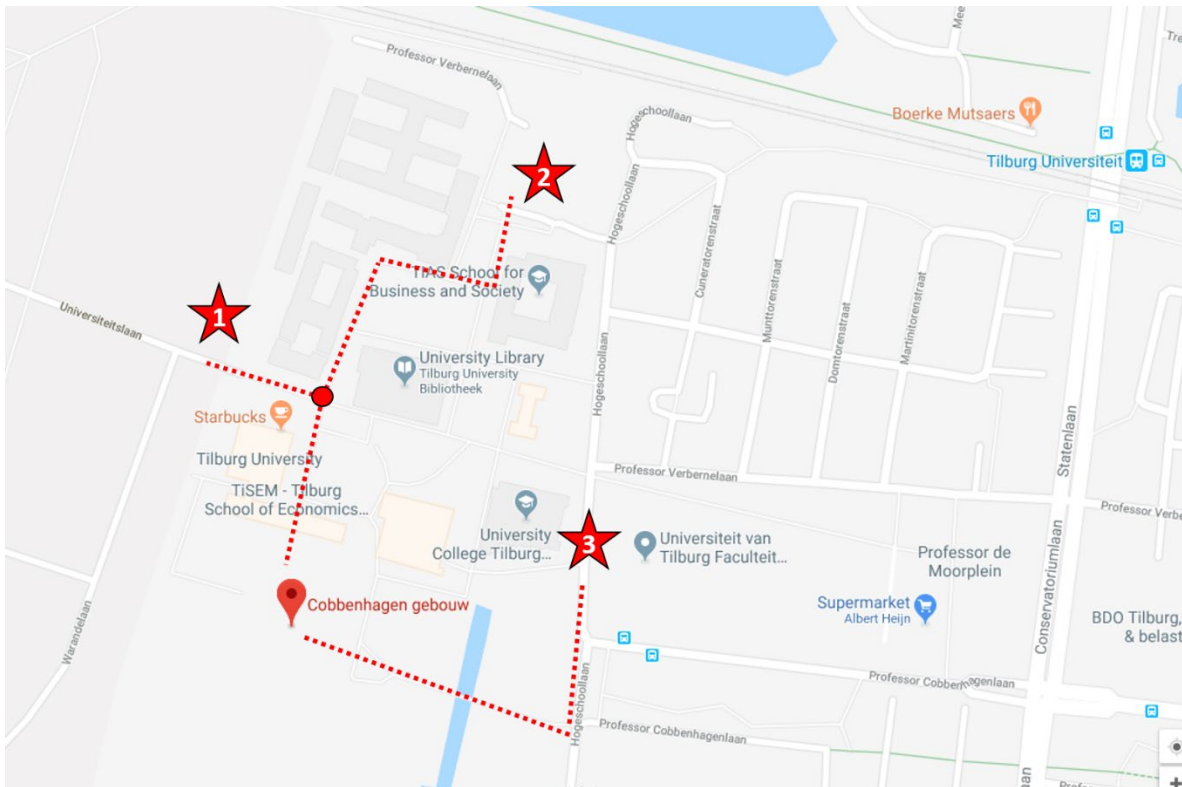

5

2

**1**

**O**

## **Notes**

## **Notes**

## **Notes**



## **Notes**

## Notes

## **Notes**